

SUSTAINABILITY DECLARATION

Monolite Bold Fåtölj



MATERIA®



Fulfills the requirements of the Möbelfakta

MATERIAL CONTENT

Wood -Plywood Birch FSC	8,25 kg	35,8 %
Steel	9,6 kg	41,6%
Aluminium	0,16 kg	0,7 %
Fabric	1 kg	4,3 %
Foam	4 kg	17,4 %
Plastic	0,05 kg	0,2 %
Total	23,06 kg	100%

Disclaimer: Material content is based on Palette chair. Numbers may vary based on model and options selected.

This applies throughout the declaration

RECYCLED MATERIAL

Post-consumer recycled content	1,92 + 0,048 =1,968 kg	8,54 %
Pre-consumer recycled content	0 kg	0%
Total recycled content	1,968 kg	8,54 %

RECYCLABILITY:

Steel	9,6 kg	41,6 %
Aluminium	0,16 kg	0,7 %
Fabric	1 kg	4,3 %
Plastic	0,05 kg	0,2 %
Total material recycling	10,81 kg	46,8 %

Wood -Plywood Birch FSC	8,25 kg	35,8 %
Foam	4 kg	17,4 %
Total energy recovery	12,25 kg	53,2 %

TOTAL CO2:



ENERGY VALUE: (in accordance with NF Environnement): 592 MJ

FULFILLED TECHNICAL STANDARDS

- EN 16139 Strength, durability and safety, for Seating and personnel weight of 110 kg.
- EN 15372 Strength, durability and safety for Tables
- EN 1728 Test methods for the determination of the strength and durability for seating
- EN 1730 Test methods for the determination of the strength and durability for Tables
- EN 1022 Determination of stability seating
- EN 1730 Determination of stability Tables
- EN 12720 Assessment of surface resistance to cold liquids
- SIS 83 91 17 Assessment of surfaces resistance to scratches
- EN ISO 105-E04 Colour fastness to perspiration

FULFILLED FIRE REQUIREMENTS

- EN 1021-1 Assessment of the ignitability of upholstered furniture – part 1: Ignition source smouldering cigarette.
- EN 1021-2 Assessment of the ignitability of upholstered furniture – part 2: Ignition source match flame equivalent
- Euroclass D

Disclaimer: Fire requirements EN 1021-1 and EN 1021-2 are based on fabric Synergy from Camira.

CHEMICAL DATA

The product does not contain:

Substances on Reach candidate list

Asbestos

Heavy metals

PVC

Hexavalent chromium

COMPANY CERTIFICATIONS

- ISO 14001
- ISO 9001
- ISO 45001

- FSC® Chain of Custody

PACKAGING AND TRANSPORT

Packaged in recyclable packaging. Materia is connected to FTI, the Swedish nationwide recycling system for packaging. Shipped with external carriers.

CARE AND MAINTENANCE RECOMMENDATIONS

Please visit our webpage.

www.materia.se

RECYCLING

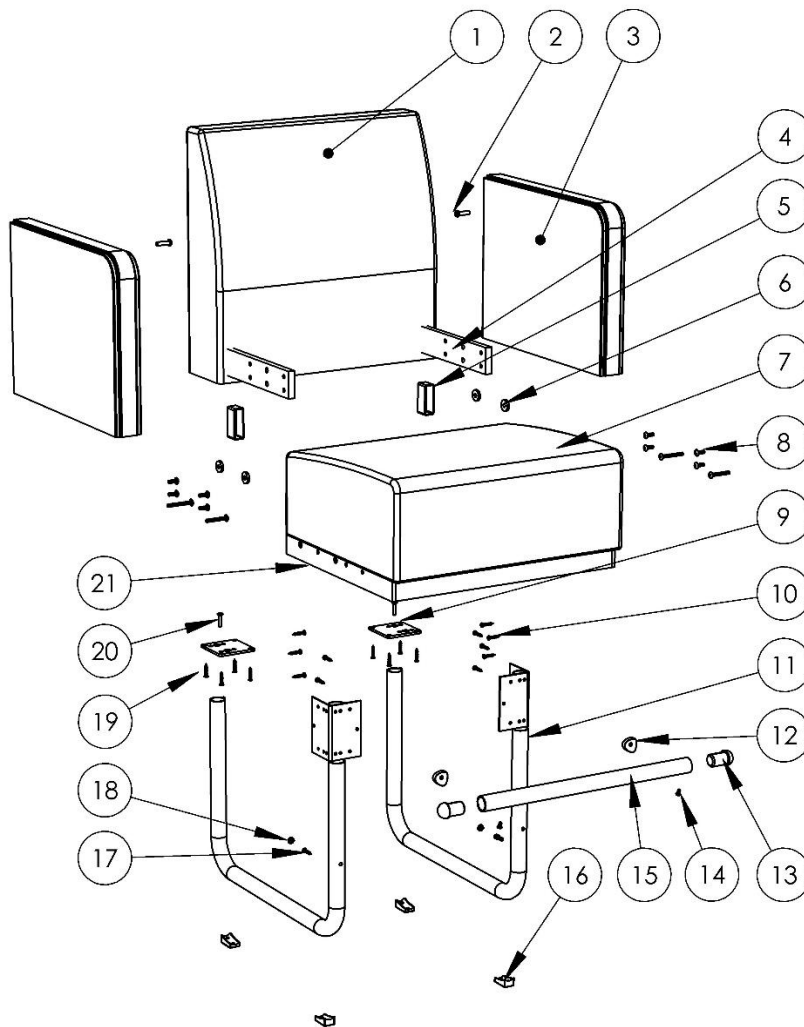

Material	ID	Disassembly	Waste fraction
Wood - Plywood Birch FSC	1,3,4,7,21	Screwdriver	Combustible waste - Wood
Steel	2,3,4,5,8,9,10,11,14,15,17,19,20	Screwdriver	Metal
Aluminium	12,13	Screwdriver	Metal
Fabric	1,3,7	Knife	Combustible waste/Textile
Foam	1,3,7	Knife	Combustible waste
Plastic	6,16,18	Knife	Plastic

*The product should in first hand be reused or remade before recycling its components.

LEED CONTRIBUTION

The product can contribute to the earning of points within the following credits.

LEED V 4 Interior Design & Construction

MR Credit: Interiors life-cycle impact reduction	services for recycling, refreshing or reusing products. Share of recyclable material in the product: 63,9 %
MR Credit: Building product disclosure and optimization – sourcing of raw materials	The product is FSC labelled as standard with the exception of some executions. Recycled content: Post consumer 63,9 %, Pre consumer 0 % Manufactured in Tranås, Sweden

Building Design and Construction

MR Credit: Building product disclosure and optimization – sourcing of raw materials	Recycled content: Post consumer 63,9 %, Pre consumer 0 % Manufactured in Tranås, Sweden
---	--

<p>MR Credit: Furniture and medical furnishings (healthcare)</p>	<p>The product contains no or less than 100ppm hexavalent chromium, heavy metals, PFCs or PFOA, or added anti-microbial treatments.</p> <p>The product is FSC labelled as standard with the exception of some executions.</p> <p>Recycled content: Post consumer 63,9 %, Pre consumer 0 %</p>
--	---

Building Operations and Maintenance

<p>MR Credit: purchasing—facility maintenance and renovation</p>	<p>The product is FSC labelled as standard with the exception of some executions.</p> <p>The product does not contain any substances on REACH Authorization or Candidate list.</p>
--	--

Verified date: 2025-03-06